

Quick Installation Guide

Ver.B (P/N: 60177A0312X00)

Included Accessories

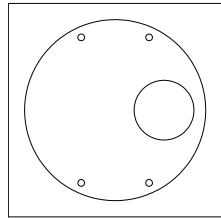

Placement sticker

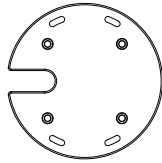

Silicon base pad



Dehumidifier packet



Mounting hardware



Quick guide

Physical Descriptions

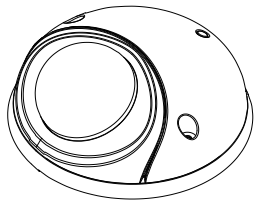

Figure 1

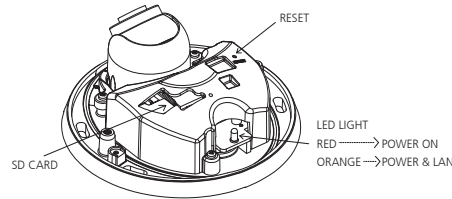

Figure 2

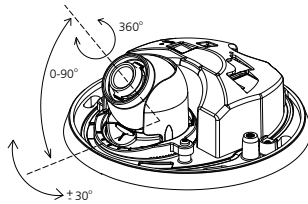

Figure 3

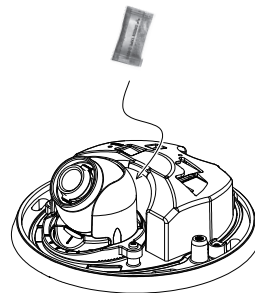
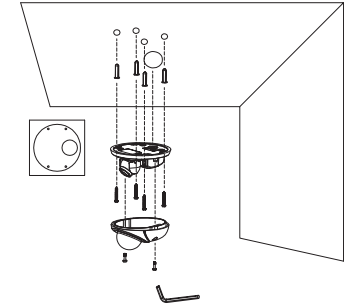

Figure 4

Hardware Installation [ceiling mount]

1. Position the placement sticker at the desired installation location
2. Drill four mounting holes, and insert the included screw anchors
3. Drill a 30mm hole for the network cable
4. Separate the top cover. Mount the camera using the supplied hardware, and adjust the lens to the appropriate position (Figure 3)
5. Put dehumidifier packet in system
6. Replace the top cover and secure it tightly using the supplied tool



Hardware Installation [wall mount]

1. Position the placement sticker at the desired installation location
2. Drill four mounting holes, and insert the included screw anchors
3. Attach the silicon base pad to the bottom of the camera (this step may be omitted if the network cable runs behind the wall)
4. Separate the top cover. Mount the camera using the supplied hardware. Run the network cable through the C-shaped base, and adjust the lens to the appropriate position (Figure 3)
5. Put dehumidifier packet in system
6. Replace the top cover and secure it tightly using the supplied tool

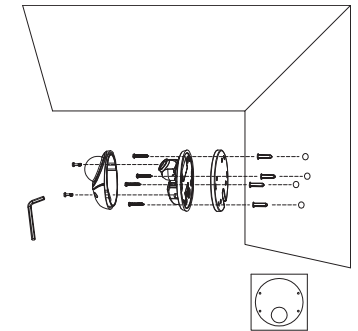

Web Browser (Internet Explorer)

1. Locate and open the Internet Explorer (IE) shortcut on the desktop.
2. In the address bar, type 192.168.1.168 (default IP address of the camera) and then press the Enter button.
3. You will be prompted with a pop-up window asking for login information, type in "admin" (default login name) and "9999" (default password)